

523 SQ.FT.
BASEMENT / GARAGE

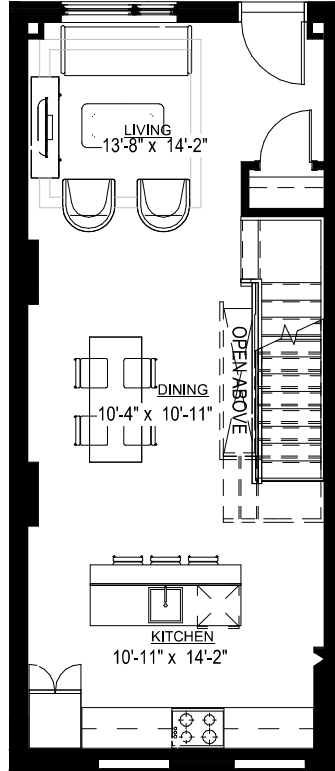

557 SQ.FT.
1ST LEVEL

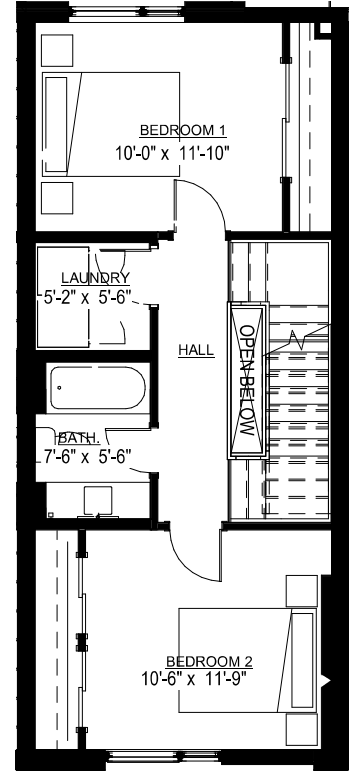

556 SQ.FT.
2ND LEVEL

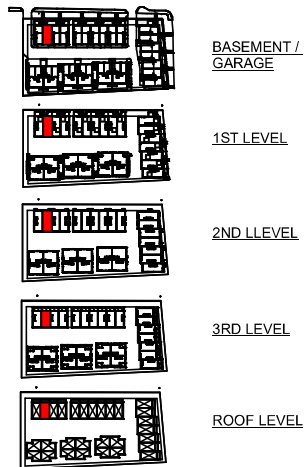

439 SQ.FT.
3RD LEVEL

UNIT 1B
318 CLIFTON ROAD
 INT.: 2,075sq. ft.
 EXT.: 81 sq. ft
 TOTAL 2,156 sq. ft.



Hobin Architecture Incorporated
 63 Pamilla Street T: 613-238-7200
 Ottawa, ON K1S 3K7 F: 613-235-2005
 hobinarc.com E: mail@hobinarc.com